

**FAG****S6000-2RSR>N**

## Deep groove ball bearing

Deep groove ball bearing S60...-2RSR, corrosion-resistant materials, single row, seals, steel sheet metal cage

## Technical information

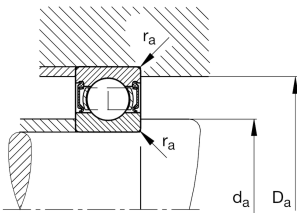
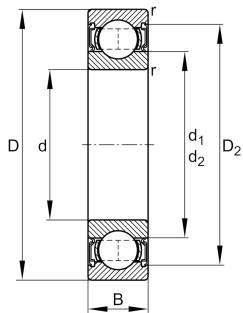

## Your current product variant

Version code	>N	Not marked on bearing
Material Bearing	S	Stainless steel
Sealing	2RSR	Contact seal on both sides
Cage	JN	Steel sheet metal
Tolerance class	PN	Normal (PN)
Dimensional / heat stabilization	SN	Rings dimensional stabilized up to 120°
Lubricant	Lubricating grease	
Radial internal clearance	CN (Group N)	Normal internal clearance
Bore type	Z	Cylindrical

## Main Dimensions &amp; Performance Data

d	10 mm	Bore diameter
D	26 mm	Outside diameter
B	8 mm	Width
C <sub>r</sub>	4,850 N	Basic dynamic load rating, radial
C <sub>0r</sub>	1,970 N	Basic static load rating, radial
C <sub>ur</sub>	122 N	Fatigue load limit, radial
n <sub>G</sub>	18,400 1/min	Limiting speed
≈m	20 g	Weight



Mounting dimensions

d a min	12 mm	Minimum diameter shaft shoulder
D a max	24 mm	Maximum diameter of housing shoulder
r a max	0.3 mm	Maximum fillet radius

Dimensions

r min	0.3 mm	Minimum chamfer dimension
D 1	21.5 mm	Shoulder diameter outer ring
D 2	22.7 mm	Caliber diameter outer ring
d 1	14.5 mm	Shoulder diameter inner ring
d 2	13.5 mm	Caliber diameter inner ring







Temperature range

T min	-30 °C	Operating temperature min.
T max	100 °C	Operating temperature max.

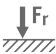
Calculation factors

f 0	12.4	Calculation factor
-----	------	--------------------

Characteristics

	Radial load
	Axial load in one direction
	Axial load in two directions
	Lifetime lubrication, freedom from maintenance
	Grease Lubrication
	Sealed on both sides
	Protected against rust